



Artemis - High Security Rifle Safe



Inner compartment for pistols, ammunition, scope storage, locked by an electronic lock.

Holds 12 to 15 rifles or shotguns (48" or 54" tall.)

Locking with 6 live action locking bolts and 6 steel dead bolts provide 12 locking points.

Highly efficient bolt detent system that keeps the bolts retracted when the door is opened and never fails to engage them automatically when the door is closed.

Re-locking feature will keep the door secured, even if the lock is completely removed during an attempted break-in; Solid steel, reinforced pry resistant door provides greater security.

Drill resistant hardened steel plate is located behind the lock for greater security.

Maintenance free heavy duty Hinges.

Main door locked by an electronic lock.

Two standard models:

Artemis 9727 - 61" H x 23" W x 20" D, weight 490 lbs

Artemis A006 - 67" H x 23" W x 20" D, weight 510 lbs

High security Rifle Safe

MGM Security Group inc

555 Wentworth St E. unit 3

Oshawa, Ontario

L1H 3V8

info@mgmsecuritygroup.com

Toll free 1-866-327-4688 - Tel 905-435-4788 - Fax 905-435-1019

www.mgmsecuritygroup.com



Options:

Hydrosorbent dehumidifier.
 Interior LED light.

This drawing cannot be reproduced without our authorization. / Ce dessin ne peut être reproduit sans notre autorisation.

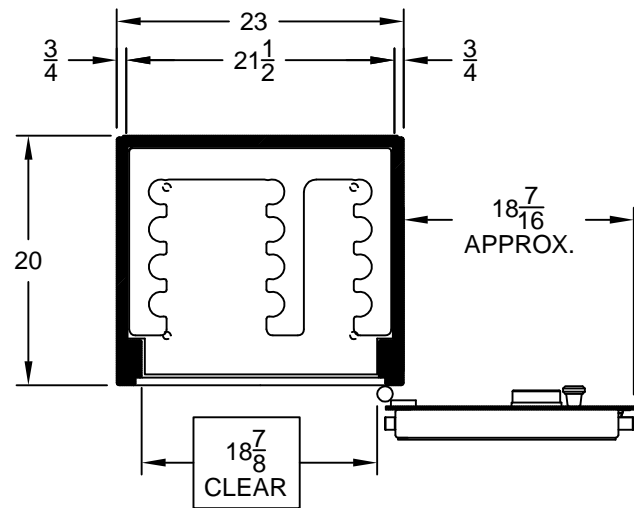

HORIZONTAL SECTION
(DOOR OPENED AT 180°)

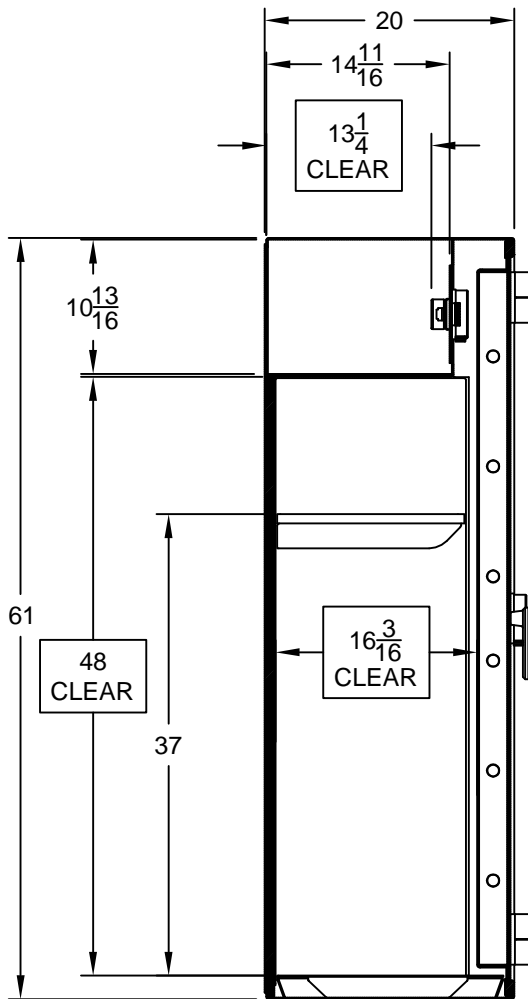

VERTICAL SECTION
(CLOSED DOOR)

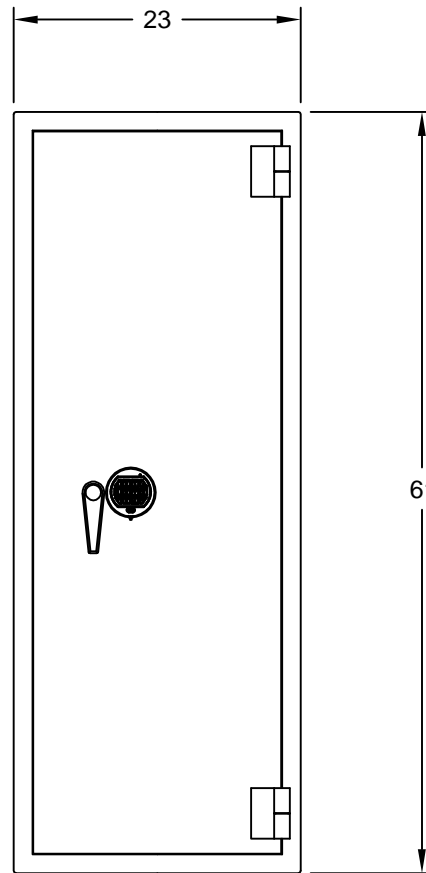

FRONT VIEW
(CLOSED DOOR)



1		COMPARTMENT DIMENSIONING ADDED	2011/02/28	Pat	Drawn by / Dessiné par : Patrick Dumas	App.	Page : 1 de 1
Rev.	Description	Date	By / Par	Scale / Echelle : 1/16"=1"	Date: 2011/02/24	Quot. / Soum. : FC-9727	
Desc.: RIFLE SAFE				Model / Modèle: 332SD-610-230-200-C1-NET	Drawing no. / Dessin no. :		Rév. 1

This drawing cannot be reproduced without our authorization. / Ce dessin ne peut être reproduit sans notre autorisation.

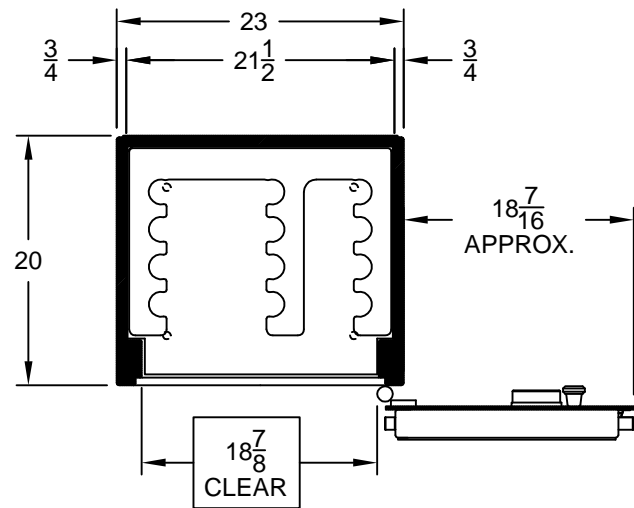

HORIZONTAL SECTION
(DOOR OPENED AT 180°)

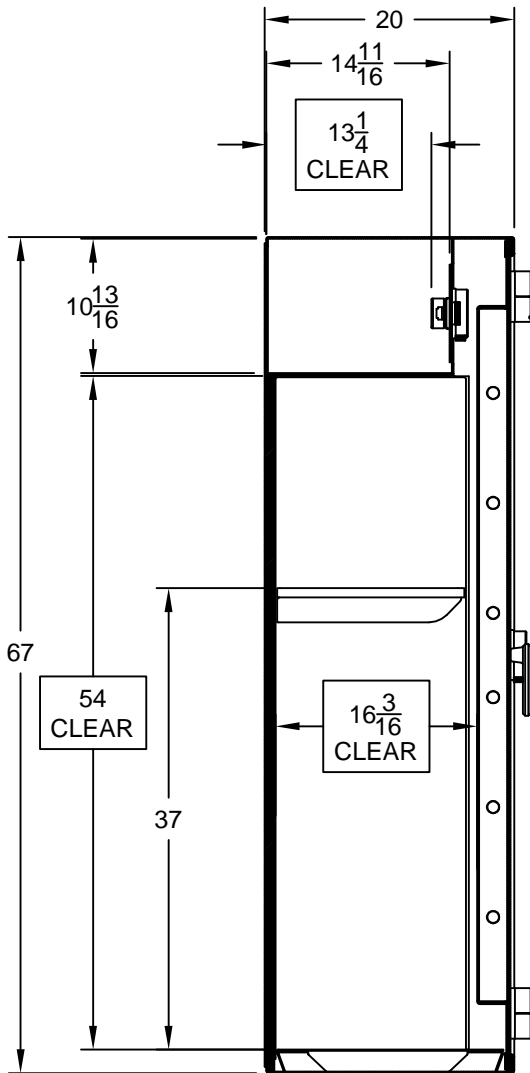

VERTICAL SECTION
(CLOSED DOOR)

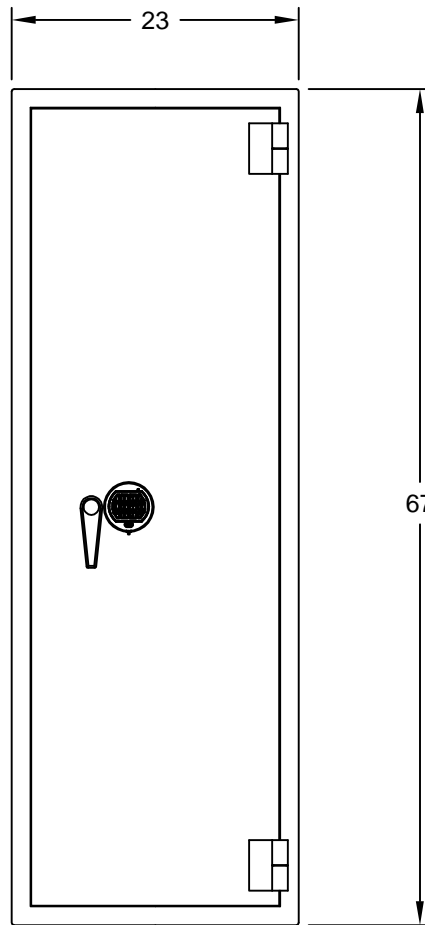

FRONT VIEW
(CLOSED DOOR)



1 COMPARTMENT DIMENSIONING ADDED			2011/02/28	Pat	Drawn by / Dessiné par : Patrick Dumas	App.	Page : 1 de 1
Rev.	Description	Date	By / Par	Scale / Echelle : 1/16"=1"	Date: 2011/02/25	Quot. / Soum. : FC-A006	
Desc.: RIFLE SAFE				Model / Modèle: Drawing no. / Dessin no : 332SD-670-230-200-C1-NET			Rév. 1